



Overnight parking by permit only. Spaces with special restrictions are marked with special signage, as seen above (yellow areas on the attached map). Permit holders are asked to park in the eastern most portion of our downtown parking lots.

Downtown Parking Program

(April 2018)

Downtown Grand Haven Residential Parking Program

Permit Questions?

616-842-3210

Enforcement & Citation Concerns?

8:00 a.m.–5:00 p.m.

616-842-3460

After Hours, Weekends, Holidays

616-994-7850



City of Grand Haven
519 Washington Avenue
Grand Haven, MI 49417
616-842-3210
www.grandhaven.org

Downtown Grand Haven, Michigan



Downtown Parking Program Grand Haven

Welcome!

Our goal is to make downtown overnight parking as convenient as possible for both residents and visitors. To purchase a permit or ask any questions, please visit the Clerk/Treasurer's Office, Monday through Friday, 8:00 a.m. to 5:00 p.m. If you have an after-hours question, please contact Ottawa Central Dispatch at 616-994-7850 and ask for an officer to contact you.

Resident Parking Registration

Resident parking permits are only available to long-term downtown residents for \$120 per year or \$10 per month.

- Downtown overnight parking registration must be completed at the City of Grand Haven Treasurer's Office located at 519 Washington Avenue.
- New applicants must provide:
 - License plate number, vehicle make and model.
 - Proof of residence in downtown district.
 - Contact number for landlord, if applicable.
- The residential permit shall be hung from the rearview mirror of the vehicle.
 - This permit is valid only for the calendar year of the permit.
- Additional information:
 - One permit per residential unit. Additional permits may be obtained upon special request (maximum two per unit).

Temporary Resident Parking Registration

Temporary resident permits are only available to downtown residents, short-term renters and building owners for \$20 per month.

- Downtown overnight parking registration must be completed at the City of Grand Haven Treasurer's Office located at 519 Washington Avenue.
- New applicants must provide:
 - Proof of residence in downtown district.
 - Contact number for landlord, if applicable.
- The permit shall be hung from the rearview mirror of the vehicle.
 - This permit is valid until the date specified on the the permit.

Visitor Parking Registration

Overnight visitors may obtain an overnight permit from the kiosk located at the corner of First and Franklin for \$5 per day.

- Overnight parking permits are available to everyone.
- Parking station permits expire daily at 9:00 a.m.
 - Permits shall be displayed on the dashboard.
 - Permits shall be displayed with the expiration date clearly visible.

Downtown Public Parking Areas

Overnight permit holders (residents and visitors) are generally encouraged to park in the eastern most sections of the downtown parking lots. [Refer to map on back.]

Enforcement & Parking Availability

- The Grand Haven Department of Public Safety is responsible for enforcing these rules and regulations.*
 - All enforcement inquiries must be directed to the Public Safety Department at 525 Washington or by telephone at 616-842-3460.
 - Vehicles may be ticketed and towed for non-compliance with parking restrictions.
 - In addition, any motor vehicle remaining in a parking space for 72 continuous hours may be deemed abandoned and is subject to impoundment pursuant to the City of Grand Haven Code of Ordinances.*
 - The City of Grand Haven may deny renewal of a permit to an applicant for non-compliance with the provisions of the Code of Ordinances of the City of Grand Haven.
- Available parking is not guaranteed.

Serving Our Downtown Residents and Visitors

Your cooperation and support is essential to the success of this program. Please take a few minutes to familiarize yourself with the parking spaces shown on this brochure. Note three hour time restrictions in many lots; these restrictions apply to all vehicles.

*[City of Grand Haven Code of Ordinances Sec. 36-38.]



Map of Downtown Parking Lots (April 2018)

Grand Haven, Michigan

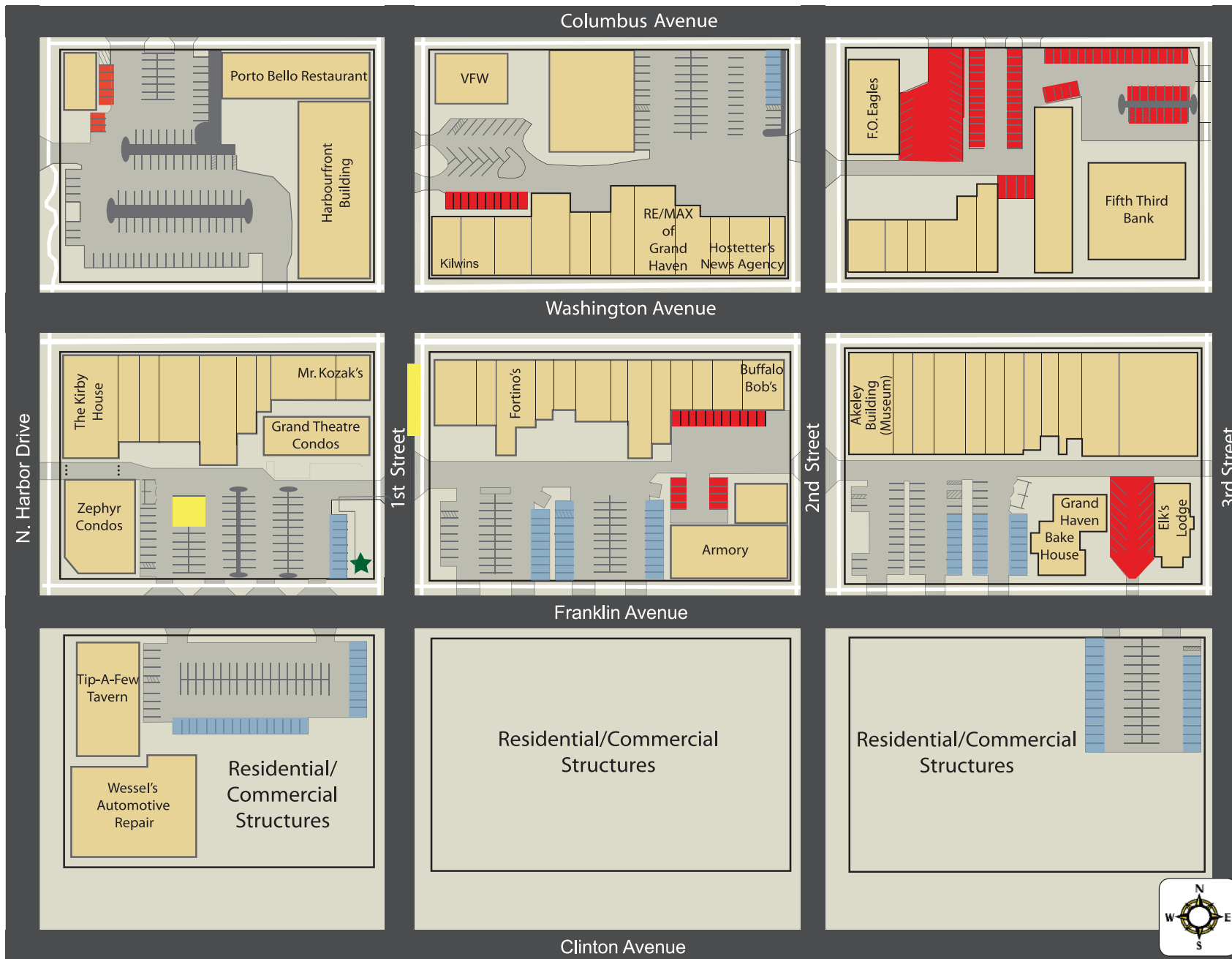

Overnight parking by permit only. Visitor permits are available from the kiosk above (located at the corner of First and Franklin) for \$5 per night. Please refer to the map for parking locations. Three hour parking 8:00 AM to 6:00 PM, May 1–November 1.

**Downtown Grand Haven
Parking Program**

Permit Questions: 616-842-3210
 Enforcement & Citations: 616-842-3460
 After Hours & Weekends: 800-249-0911

Parking Map Legend

- Recommended Overnight Parking
- Parking Permit Kiosk (1st & Franklin)
- Reserved Parking (No Public Parking)
- Special Rules

Please park in recommended spaces only